

AG Neovo E-17
Smart Performance

Thank you for choosing AG Neovo E-17.

E-17 is compliant with VESA standard mount, allowing quick mounting for easy and convenient use.

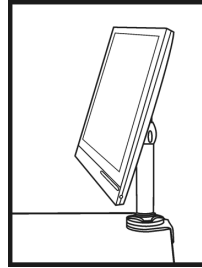

<<Mounted with height adjustable stand>>

For any installation of the display facing downwards, it is compulsory to install clips for safety protection.

See **Clips Installation Guide** for detailed instruction.

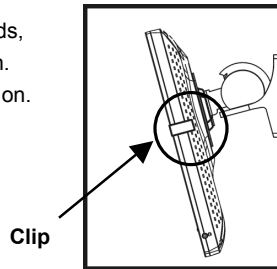

<< While facing downwards>>

Caution

Each E-17 comes with a pair of clips. If the display is not for desktop usage and mounted to face downwards, please install the clips for extra safety protection. For the proper use of E-17, please follow strictly with the instruction in User Manual. Without prior advice from AG Neovo, AG Neovo assumes no responsibility for inappropriate installation, including without limitation ceiling mount, or the consequential damage for the use of inappropriate system design.



*Ceiling mount or mount on any other horizontal surface overhead are not advisable

Please contact local AG Neovo service office for any installation inquiry.

• **Europe:**
service.nl@agneovo.com

• **North and South America:**
service.us@agneovo.com

• **Asia Pacific & Africa**
service@agneovo.com

• **Other Countries**
service@agneovo.com

Clips Installation Guide

Before E-17 is set to face downwards, please install the clips for safety protection.

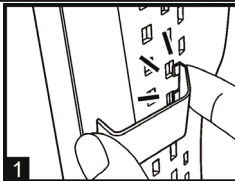
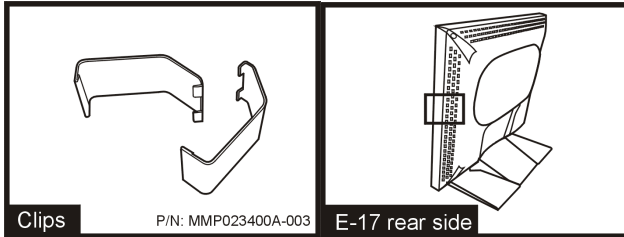

Find two adjacent holes on the centre of the second row.

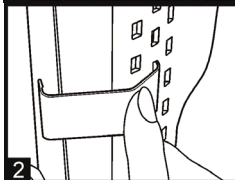

Fix the clip in the holes.

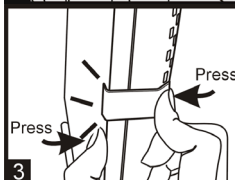

Click!!

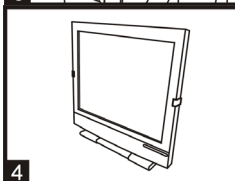

Clips are properly seated on the display.

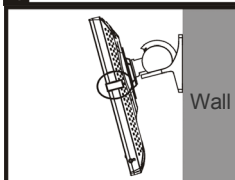

Completed.